



Model ZGI40

Ground Independent Mobile Antenna
1.1 metre

27 MHz Land CB Radio 2.1 dBi

- Recommended for vehicle bull bar, guard, the boot of a sedan or truck mirror
- Mounts into any bracket with minimum 12.7 mm (½") diameter hole.
- 4.5 metres of RG58 low loss stranded cable.
- UHF male solder connector supplied, not fitted.
- 50 watts maximum input power.

INSTALLATION GUIDE

www.zcgc.com.au

ANTENNA DESCRIPTION

ZGI40 is a ground independent 27 MHz land CB radio mobile antenna specifically designed for mounting to the bull bar, guard or boot of a vehicle, or to a truck mirror.

Standing 1.1 metres tall, the antenna delivers 2.1 dBi gain. The high quality chrome plated brass, delrin, copper and fibreglass construction will survive harsh Australian conditions for many years.

4.5 metres of RG58 low loss stranded cable bottom exits through the mounting base. The cable is not terminated to allow easy installation through vehicle firewalls and dashboards.

It is recommended that the cable be cut to the shortest length necessary prior to fitting the UHF male solder connector provided.

A detailed specification sheet is available to download from www.zcgc.com.au

TUNING

The antenna has been tuned in the factory for the 27 MHz land CB radio frequency.

VSWR has been optimised to better than 1.5:1.

This tuning cannot be altered.

SELECTING THE MOUNTING POSITION

No metal ground plane is necessary for the antenna to operate effectively.

Typical mounting positions for this antenna are to a vehicle bull bar or guard, the boot of a sedan or truck mirror using the appropriate bracket with minimum 12.7 mm (½") diameter hole.

The antenna can also be mounted in locations other than on a vehicle.

To achieve best performance from your antenna, these are the important principles you should consider when selecting the mounting point:

1. **Mount the antenna in as high a place as possible.**
2. **Mount the antenna as far away from other antennas and metallic objects as possible to avoid interference and distortion of the 360° omnidirectional pattern. At least 350 mm side clearance is desirable, preferably more.**
3. **Mount the antenna vertical, not at an angle.**

INSTALLATION GUIDE

Remove the nut and washer from the threaded base and slip them off over the cable. Pass the cable through the hole of your mounting bracket. Thread the washer and nut back up the cable and onto the threaded base.

From underneath, tighten the nut to secure the antenna firmly to the bracket.

IMPORTANT : *Leave some slack in the cable at the point where the cable bottom exits through the base. This will allow the antenna to flex in the usual manner during travel.*

Route the RG58 low loss stranded cable carefully. Avoid high heat areas in the engine bay. Ensure that the cable is not stretched excessively and there are no sharp kinks.

Use cable ties, but do not pull so tight as to crush the cable. A damaged feeder cable is a cause of high VSWR and reduced performance.

We recommend that you cut the cable to the shortest length necessary, prior to fitting the UHF male connector provided.

Carefully strip the end of the coaxial cable as shown in the diagram.

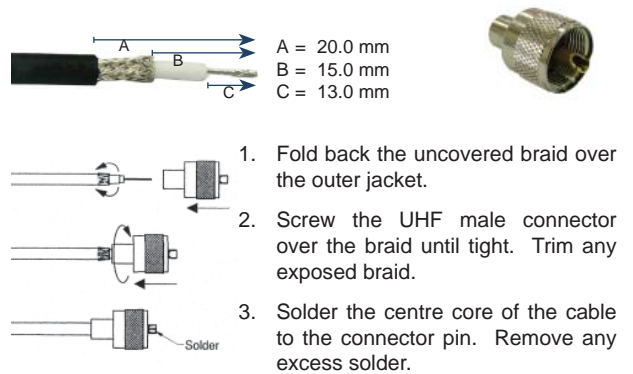

Attach the connector to your radio. The maximum input power is 50 watts.

Installation is now complete.

